

NEW ALBANY LSMU-PODS C, D, E & A PORTION OF ENTERPRISE CENTER BOULEVARD BEING A REPLAT OF A PORTION OF PARCEL A-2, BOYNTON BEACH ENTERPRISE CENTER PLAT No. 2, AS RECORDED IN PLAT BOOK 79, PAGES 152 THROUGH 155 OF THE PUBLIC RECORDS OF PALM BEACH COUNTY, FLORIDA IN SECTION 28, TOWNSHIP 45 SOUTH, RANGE 42 EAST, PALM BEACH COUNTY, FLORIDA

SHEET 2 OF 4 DECEMBER 1999

- LEGEND: R = RADIUS, L = ARC LENGTH, D = DELTA (CENTRAL ANGLE), P.O.B. = POINT OF BEGINNING, P.O.C. = POINT OF COMMENCEMENT, P.R.M. = PERMANENT REFERENCE MONUMENT, P.C.P. = PERMANENT CONTROL POINT, LWDD = LAKE WORTH DRAINAGE DISTRICT, L.B. = LICENSED BUSINESS, N = NORTHING (GRID), E = EASTING (GRID), O.R.B. = OFFICIAL RECORD BOOK, PG. = PGS., P.R.M. "PRM LB 4318", P.C.P. "PCP LB 4318", FPL = FLORIDA POWER & LIGHT COMPANY, U.E. = UTILITY EASEMENT, L.A.E. = LIMITED ACCESS EASEMENT, P.B. = PLAT BOOK, PGS. = PAGES, O.S.C.E. = OPEN SPACE CONSERVATION EASEMENT

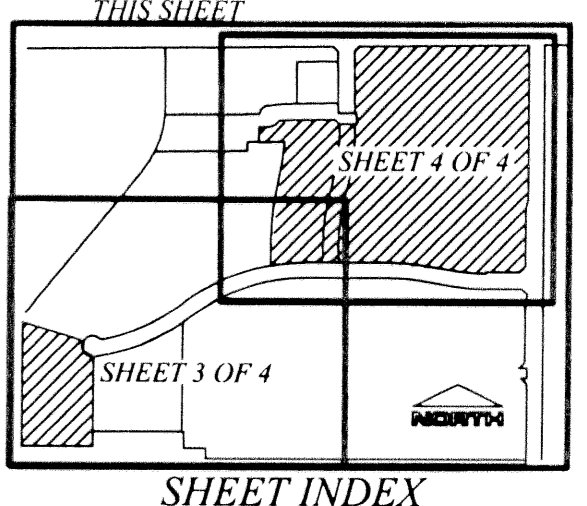

NEW ALBANY LSMU-PODS C, D, E & A PORTION OF ENTERPRISE CENTER BOULEVARD NICK MILLER, INC. Surveying & Mapping Consultants SHEET NO. 2 of 4 SCALE: 1" = 100' DATE: DECEMBER 1999 JOB NO. 99015A FILE: 99015A(1).DWG

SUBDIVISION, PARCEL, FLOOD MAP#, FLOOD ZONE, ZONING, ZONING CODE, TAZ, PUB NAME

LAKE WORTH DRAINAGE DISTRICT CANAL E-2-E 50' ROADWAY PER P.B. 2, PAGE 45 AND O.R.B. 1585, PAGE 505

P.O.C. DESCRIPTION 1 SOUTHEAST CORNER OF BOYNTON BEACH ENTERPRISE CENTER PLAT No.2 P.B. 79, PGS. 152-155

P.O.B. LIMITS OF PLAT S 89°59'57" W 368.88'

PARCEL B-3 BOYNTON BEACH ENTERPRISE CENTER REPLAT No.3 P.B. 80, PGS. 160-161

PARCEL D SEE SHEET 3 OF 4

R=53.00' L=129.86' D=140°22'51" 5' L.A.E.

LIMITS OF PLAT S 74°59'58" E 335.08'

PARCEL C NEW ALBANY P.U.D. P.B. 86, PGS. 4-6

PARCEL A NEW ALBANY P.U.D. P.B. 86, PGS. 4-6

PARCEL B NEW ALBANY P.U.D. P.B. 86, PGS. 4-6

GRAPHIC SCALE (IN FEET) 1 inch = 100 ft.

FLORIDA'S TURNPIKE INTERCHANGE PARCEL O.R.B. 6269, PGS. 403-411

BOYNTON BEACH BOULEVARD 145' RIGHT OF WAY PER P.B. 2, PG. 45 & PER O.R.B. 6269, PG. 410

PARCEL B BOYNTON BEACH ENTERPRISE CENTER PLAT No.2 P.B. 78, PGS. 40-41

PARCEL 1 SHOPPES AT NEW ALBANY M.U.P.D. P.B. 86, PGS. 11-12

P.O.C. DESCRIPTION 2 NORTHWEST CORNER PARCEL A-2 BOYNTON BEACH ENTERPRISE CENTER PLAT No.2 P.B. 79, PGS. 152-155